



NIRALA ESTATE

2,3 & 4 BHK APARTMENTS
GH-04, TECHZONE-IV, G. NOIDA WEST



The most adorable place...



A Vision backed by Commitment

With a vision to provide 'an enhanced lifestyle at an affordable price while at the same time creating a sustainable future' Nirala World aspires to become a market leader by offering iconic and world-class real estate properties.

Nirala World is being pioneered by the leading luminary from the business arena under his dynamic leadership of professional management the Group seeks to build homes that fulfill the aspirations of the emerging India. The group is also committed to construct homes which while being affordable boast of quality in construction and are delivered on time. Undoubtedly the Group has created unparalleled residential, commercial and business infrastructure that has withstood the test of time.

The projects of Nirala World are all situated at prime locations. They offer unmatched luxury while at the same time not losing the affordability tag. The project portfolio of the Group includes:

- **PAN Oasis** at Sector-70, Noida.
- **Eden Park** at Sector-50, Noida.
- **Eden Park - I** at GH-5, Ahinsa Khand-II, Indirapuram, Ghaziabad.
- **Eden Park - II** at Ahinsa Khand-II, Indirapuram, Ghaziabad.



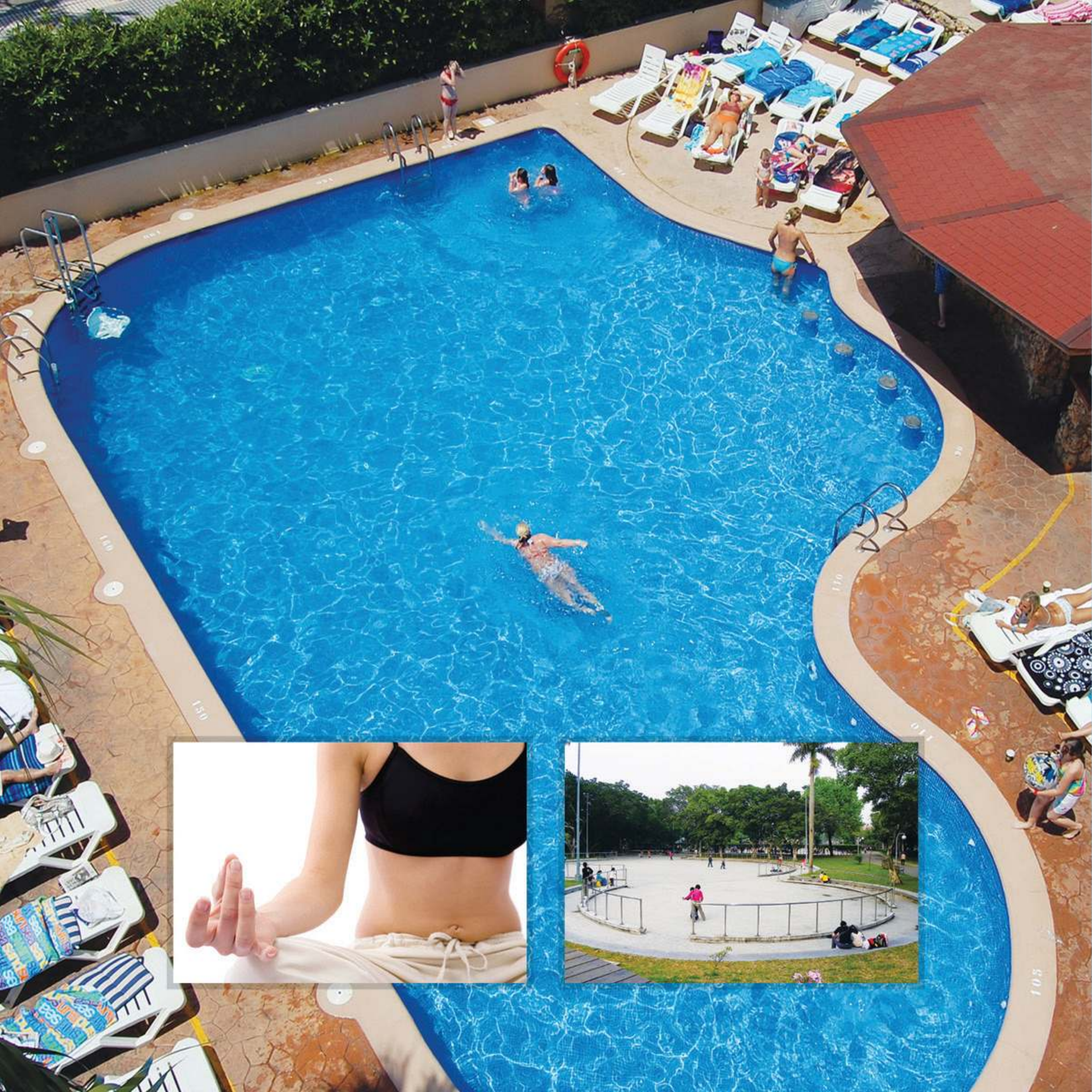

The Abode of Tranquility

It's like living in at one of the most serene places. It's a home you will cherish. That's the beauty of Nirala Estate, inspired by the charm of modern and contemporary lifestyle. Nirala Estate not only promises to herald the dawn of a majestic lifestyle but it also has the portents to completely redefine your expectations from a home. All at a price that is truly affordable. Rest assured that life here would be one big celebration with all the concomitant pomp and show. Your home here would be a head turner and amongst the graceful residential complexes. Nirala Estate is a joint venture of Nirala World and the promoters of SMC Group of brand Madhusudan Ghee fame.

Situated in one of the most sought after and fast developing localities of NCR Delhi, Nirala Estate is one gem of an apartment complex. Within easy reach from Delhi, Noida and Ghaziabad it is ensconced with sumptuous greenery and well-planned localities, reputed schools, state-of-the-art hospitals, multiplexes and malls are all within easy reach. You sure would love the place and all the facilities it offers. Rest assured that Nirala Estate would turn your life into one big joyous occasion.

Location Advantages / Project Highlights

- Approx 20 Min drive from DND FLYOVER • Approx 10 Min drive from GOLF COURSE
- Approx 15 Min drive from SECTOR-18 & ATTA MARKET • Approx 10 Min drive from existing METRO STATION
- Approx 10 Min drive from FORTIS HOSPITAL • Approx 10 Min drive from SAI MANDIR
- Almost all flats 3 side open • Located in the heart of TECH-ZONE-4
- Nearby top most ENGINEERING/MANAGEMENT COLLEGE



FLOOR PLAN

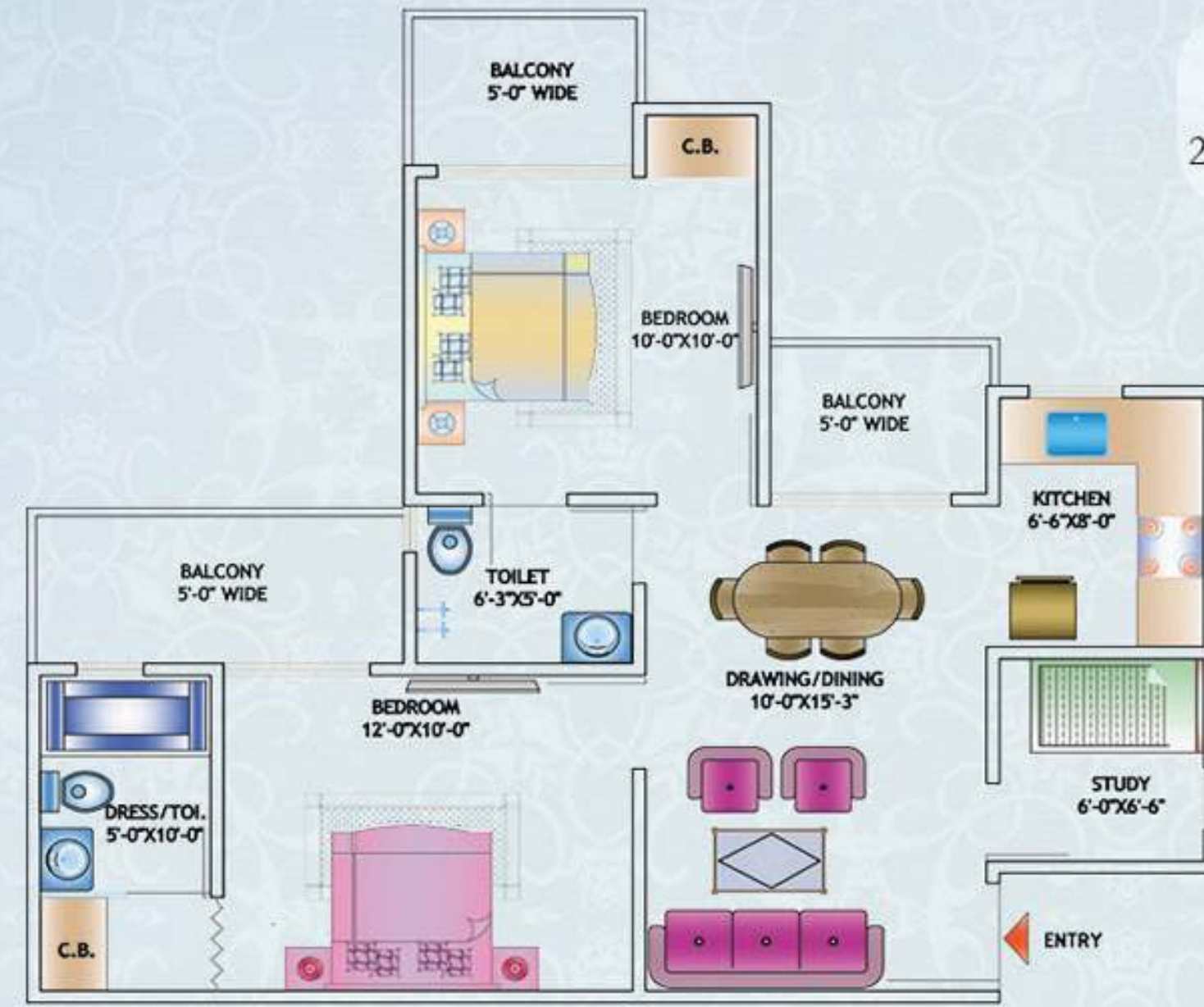

Type - 2BR, 88.72 Mtr.² (955 Sq.Ft.)
2 Bedroom + 2 Toilets + Study + Dress (Small)

1 sq. mt. = 10.764 sq. ft.

FLOOR PLAN

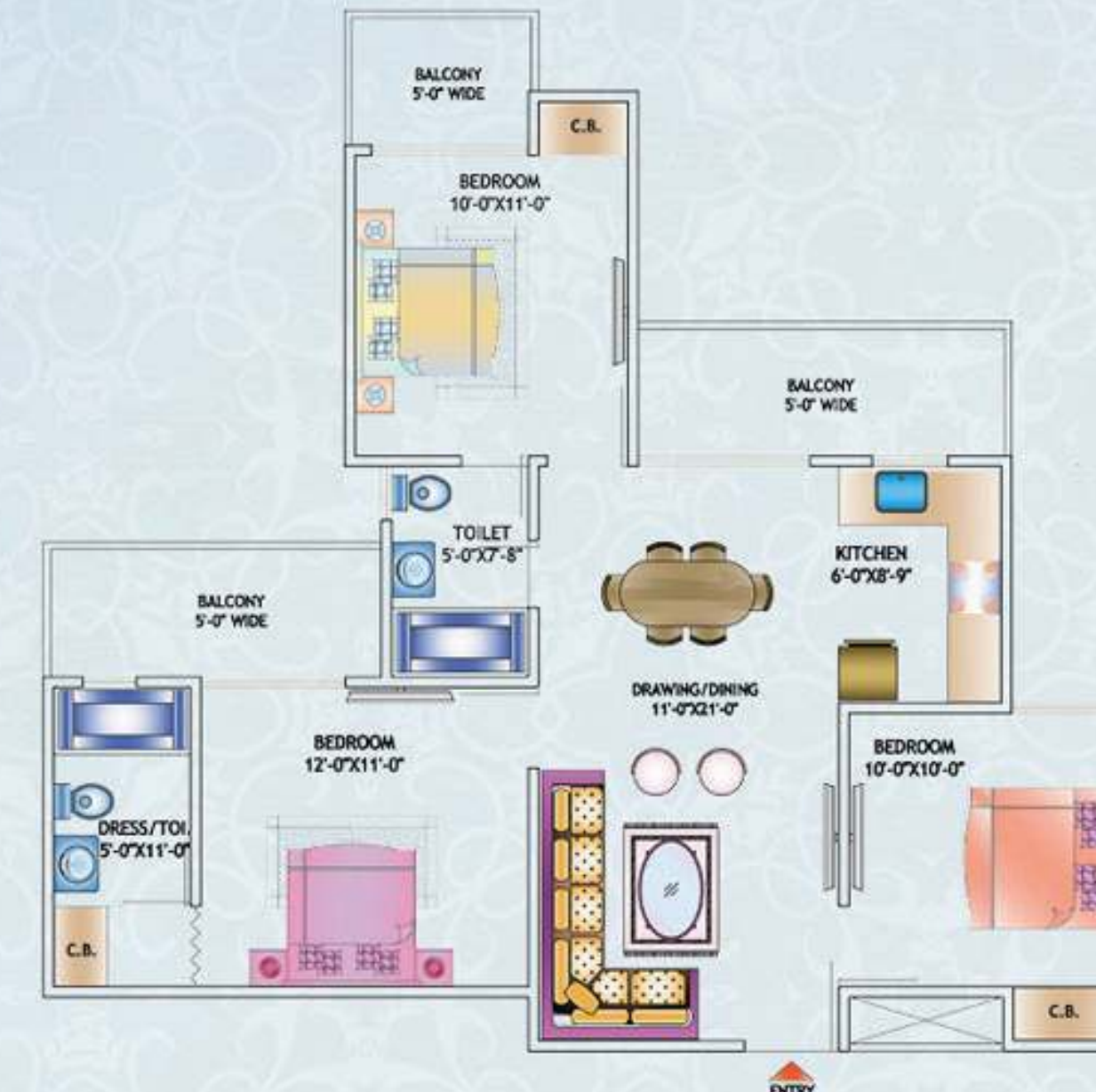

Type - 3BR, 115.66 Mtr.² (1245 Sq. Ft.)
3 Bedroom + 2 Toilets + Dress (Small)

1 sq. mt. = 10.764 sq. ft.

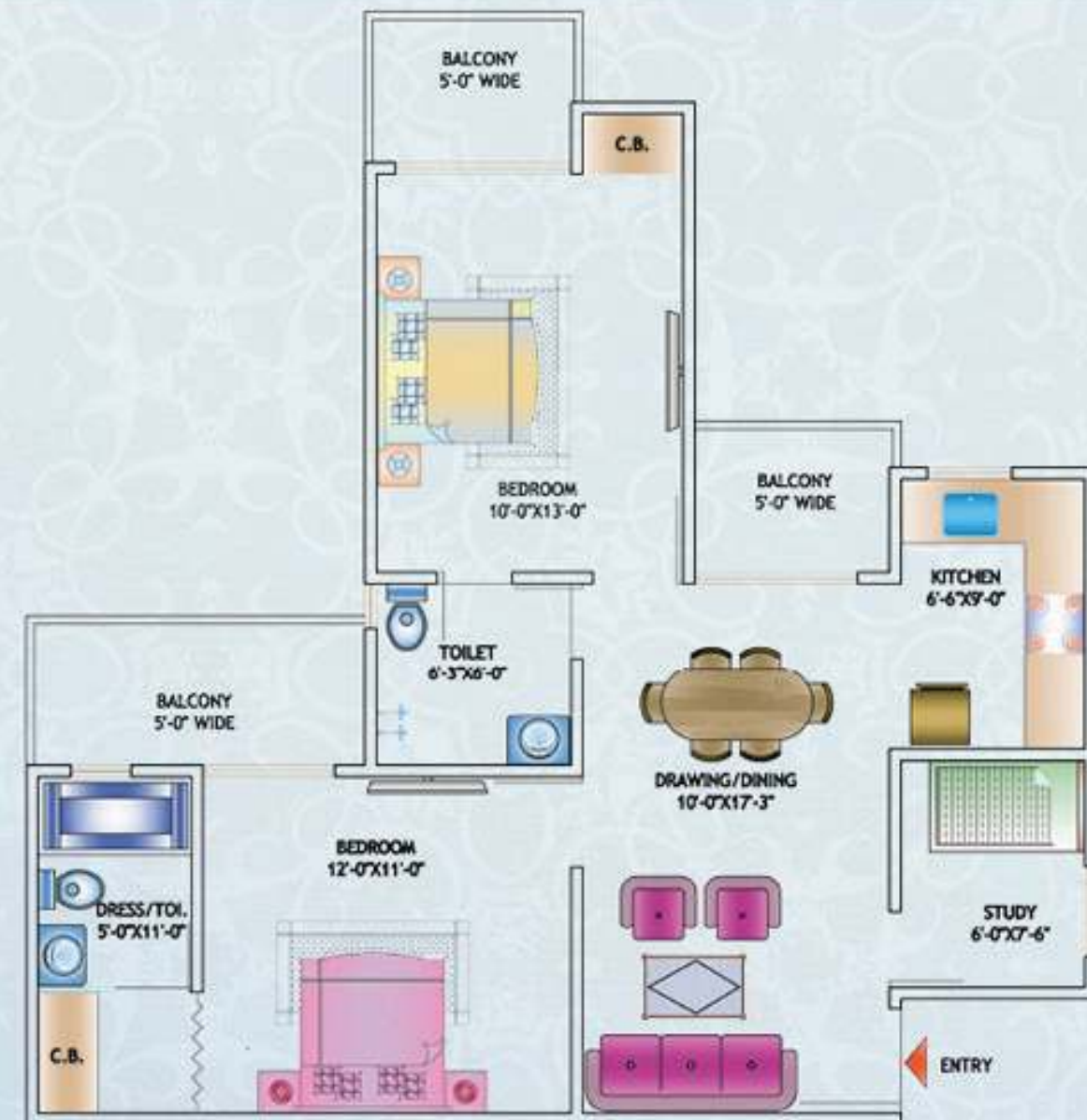

Type - 2BR, 100.33 Mtr.² (1080 Sq. Ft.)
2 Bedroom + 2 Toilets + Study + Dress (Big)

1 sq. mt. = 10.764 sq. ft.

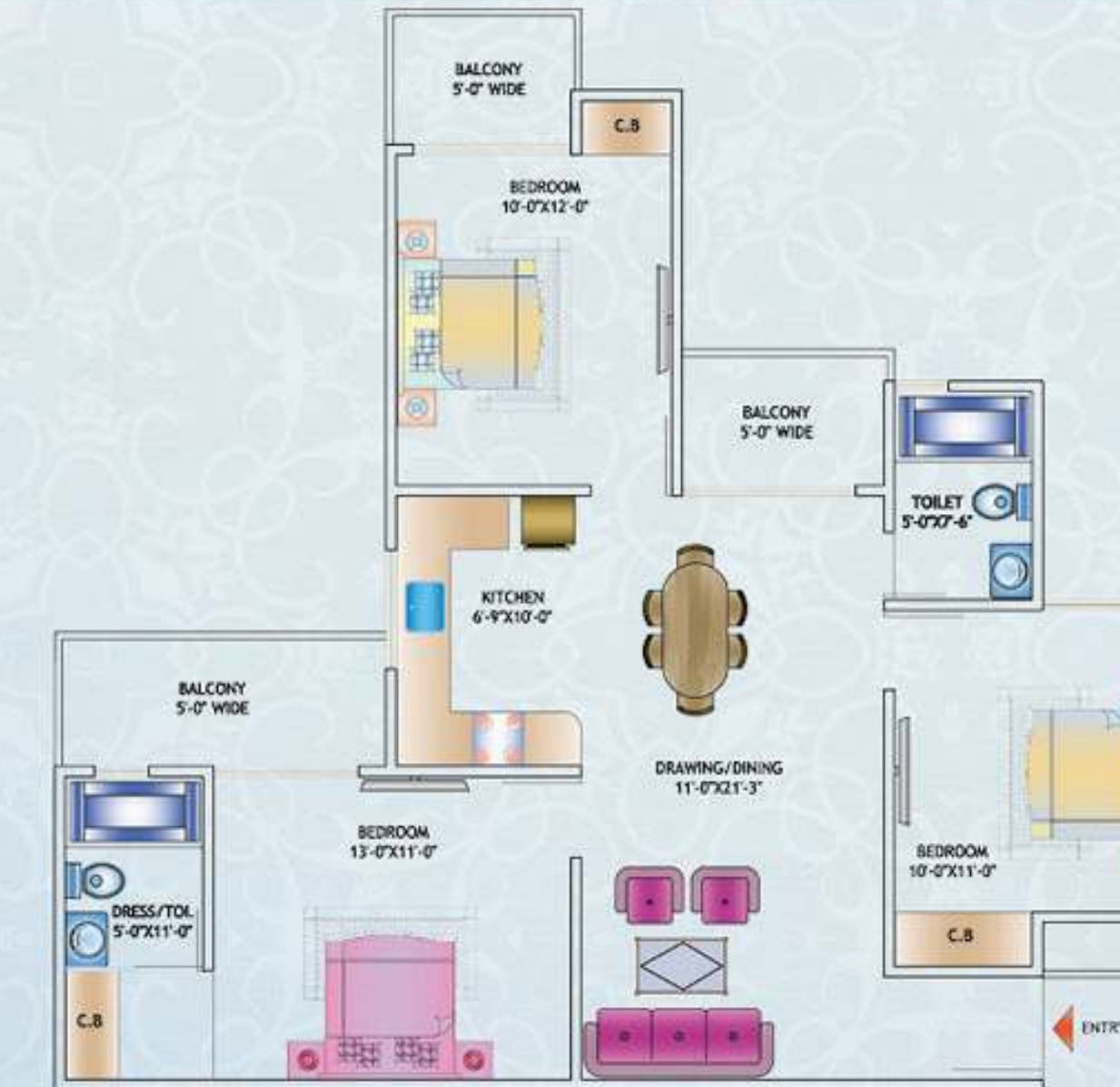

Type - 3BR, 124.02 Mtr.² (1335 Sq. Ft.)
3 Bedroom + 2 Toilets + Dress (Big)

1 sq. mt. = 10.764 sq. ft.

FLOOR PLAN

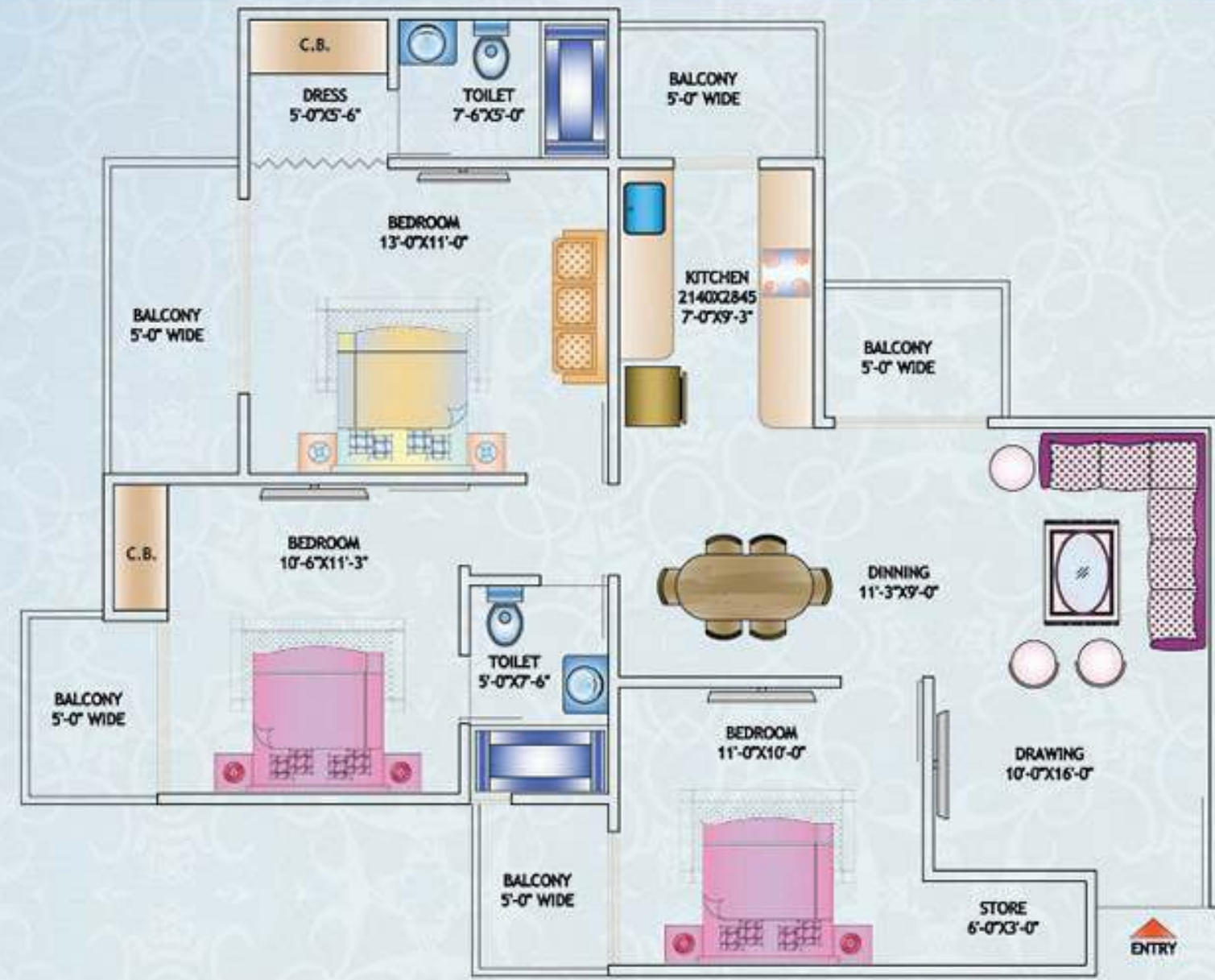

Type - 3BR, 133.77 Mtr.² (1440 Sq.Ft.)
3 Bedroom + 2 Toilets + Store + Dress

1 sq. mt. = 10.764 sq. ft.

FLOOR PLAN

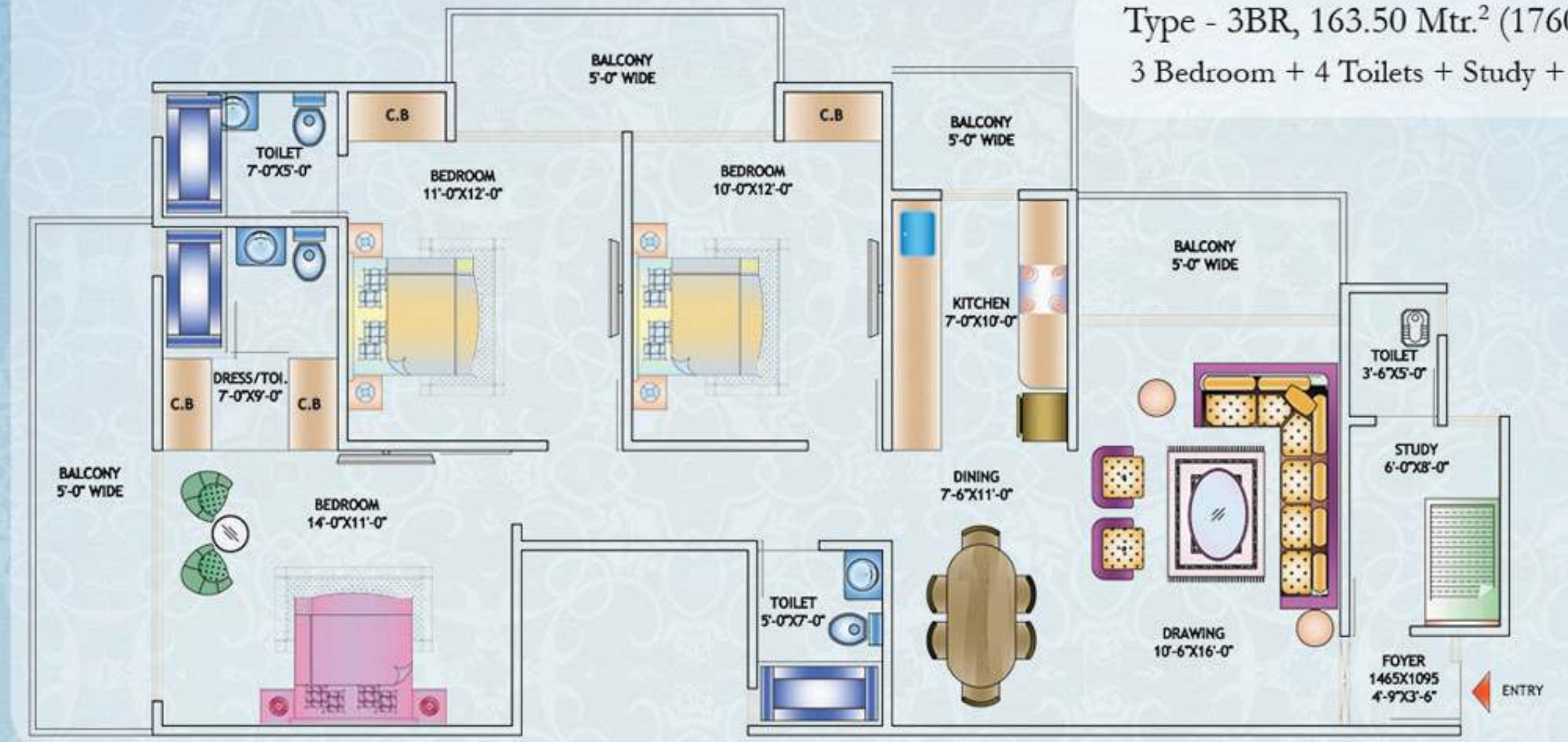

Type - 3BR, 163.50 Mtr.² (1760 Sq. Ft.)
3 Bedroom + 4 Toilets + Study + Dress - B

1 sq. mt. = 10.764 sq. ft.

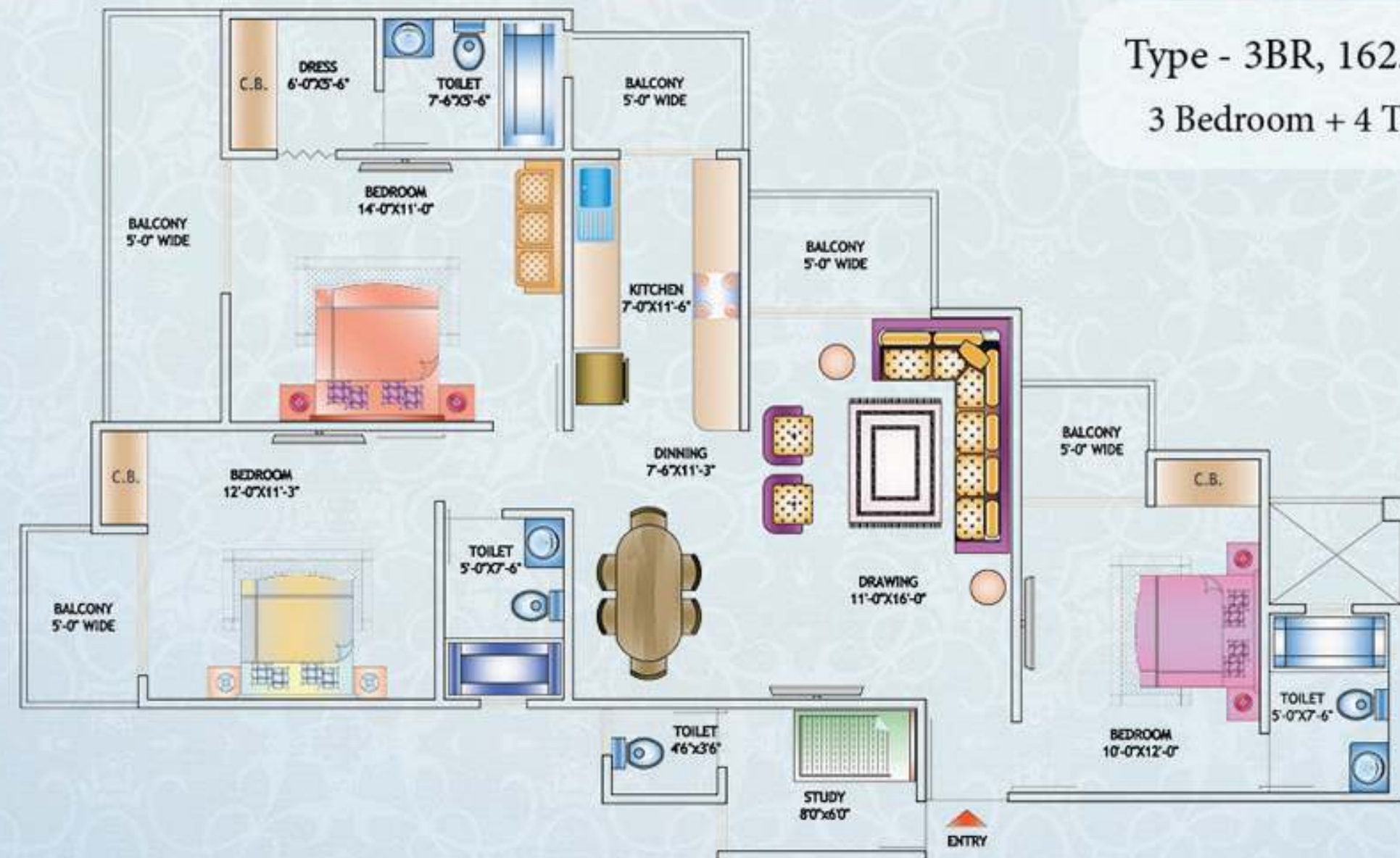

Type - 3BR, 162.11 Mtr.² (1745 Sq. Ft.)
3 Bedroom + 4 Toilets + Study + Dress - A

1 sq. mt. = 10.764 sq. ft.

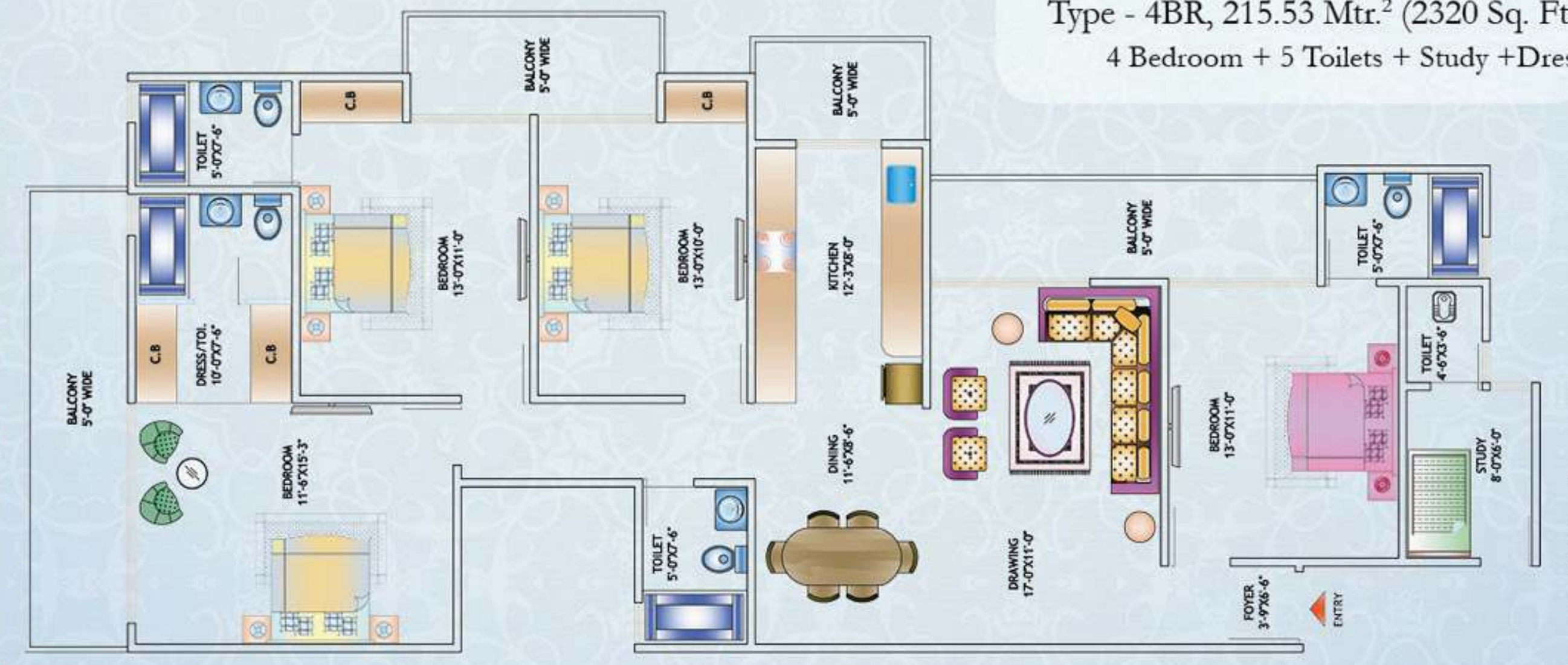

Type - 4BR, 215.53 Mtr.² (2320 Sq. Ft.)
4 Bedroom + 5 Toilets + Study + Dress

1 sq. mt. = 10.764 sq. ft.

SPECIFICATIONS

FLOORING

- Vitrified tiles 2'x2' in Drawing Room, Kitchen and all Bedrooms
- Ceramic tiles in Servant Room, Bathrooms and Balconies

WALL & CEILING FINISH

- Finished walls & ceiling with OBD in pleasing shades

KITCHEN

- Granite working top & stainless steel sink with drain board
- 2'-0" dado above the working top by ceramic tiles

TOILETS

- Ceramic tiles on walls upto door level
- White sanitary ware of Hindware, imported or equivalent
- CP fitting of Jaquar / imported or equivalent

DOORS & WINDOWS

- Outer doors & windows aluminium powder coated
- Internal door-frames of Marandi or equivalent wood
- Internal door-flush door of designer look
- Main entry door frame of Marandi or equivalent wood with flush door of Designer Look
- Good quality hardware fittings

ELECTRICALS

- Copper wire in PVC conduits with MCB supported circuits and adequate number of points and light points on the ceilings

TV & TELEPHONE

- One landline connection with intercom facilities
- Provision for DTH/IPTV connection

POWER BACKUP

- 100% DG power back-up for all common areas
- 100% DG power back-up available to individual flat on paid basis

SECURITY SYSTEM

- Secured gated community

LIFT LOBBY

- High speed passenger elevators
- Lift lobby floor-combination of one or more of marble/granite/vitrified tiles

STAIRCASES

- Floor-Terrazzo/Mosaic tiles/ Marble stone
- Wall-dry distemper

SITE PLAN

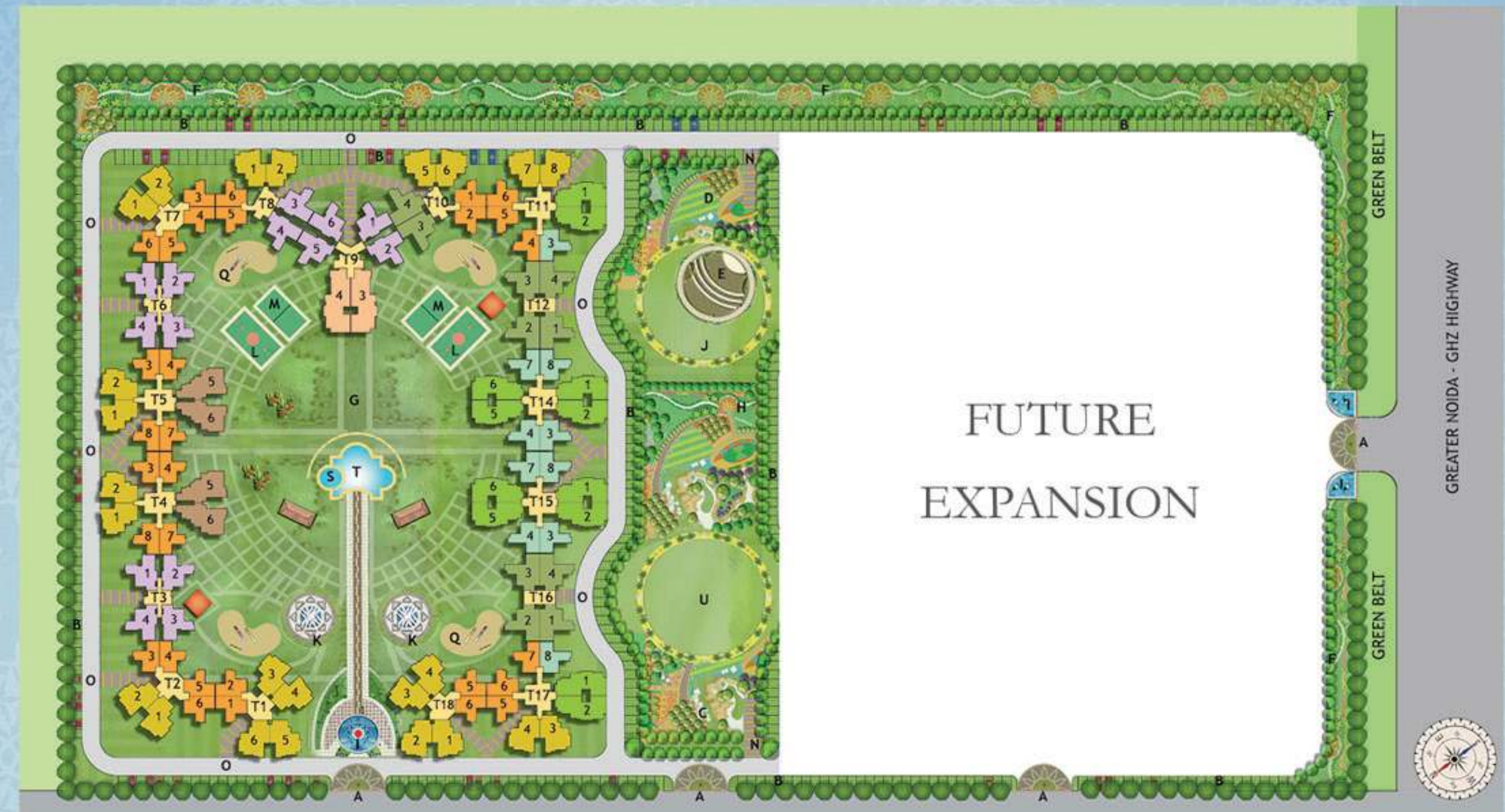

LEGENDS

- | | | | |
|---------------------------|---------------------------|----------------|-----------------------------------------------|
| A. Main Entrance / Exit | L. Basketball Court | (955 Sq.Ft.) | 2 Bedroom + 2 Toilets + Study + Dress (Small) |
| B. Parking | M. Tennis Court | (1080 Sq. Ft.) | 2 Bedroom + 2 Toilets + Study + Dress (Big) |
| C. Palm Plaza | N. Ramp | (1245 Sq. Ft.) | 3 Bedroom + 2 Toilets + Dress (Small) |
| D. Bamboo Court | O. Drop-off Area | (1335 Sq. Ft.) | 3 Bedroom + 2 Toilets + Dress (Big) |
| E. Amphitheater | P. Pavilion | (1440 Sq.Ft.) | 3 Bedroom + 2 Toilets + Store + Dress |
| F. Jogging Track | Q. Children's Play Area | (1745 Sq. Ft.) | 3 Bedroom + 4 Toilets + Study + Dress - A |
| G. Lawn | R. Club House | (1760 Sq. Ft.) | 3 Bedroom + 4 Toilets + Study + Dress - B |
| H. Reflexology Path | S. Jacuzzi | (2320 Sq. Ft.) | 4 Bedroom + 5 Toilets + Study + Dress |
| I. Water Tunnel with Jets | T. Beach Pool | | |
| J. Yoga / Meditation Area | U. Outdoor Gathering Area | | |
| K. Skating Rink | | | |

LOCATION MAP



EXISTING & UPCOMING PROJECTS



NIRALA EDEN PARK-I, INDIRAPURAM



EDEN PARK SECTOR-50, NOIDA



PAN OASIS SECTOR-70, NOIDA



NIRALA ESTATE GNOIDA (W)



NIRALA EDEN PARK-II, INDIRAPURAM



NIRALA EDEN PARK, NH-24 GZB.



NIRALA SPLENDORA, GNOIDA (W)



NIRALA ESTATE PHASE-2



Nirala Infratech Private Limited

Corp. Off: H-61, Ist & IInd Floor Sector-63, Noida • Tel.: 0120 4823000, Fax: 0120 4823001

Site Off: GH-04, Techzone-IV, Gr. Noida (West), U.P.

Email: sales@niralainfratech.com | Website: www.niralainfratech.com